



# Cruiser 40 S. Concept & Status.

# Cruiser 40 S. Basic Concept. Hull.

Hull using 18/20mm core

The two graphics do illustrate the current status of interior structure (left) with the structure required by using 20mm Core (right).  
The red marked shelves are actually doublings and triples plus extensive lamination work for application – which will get obsolete.

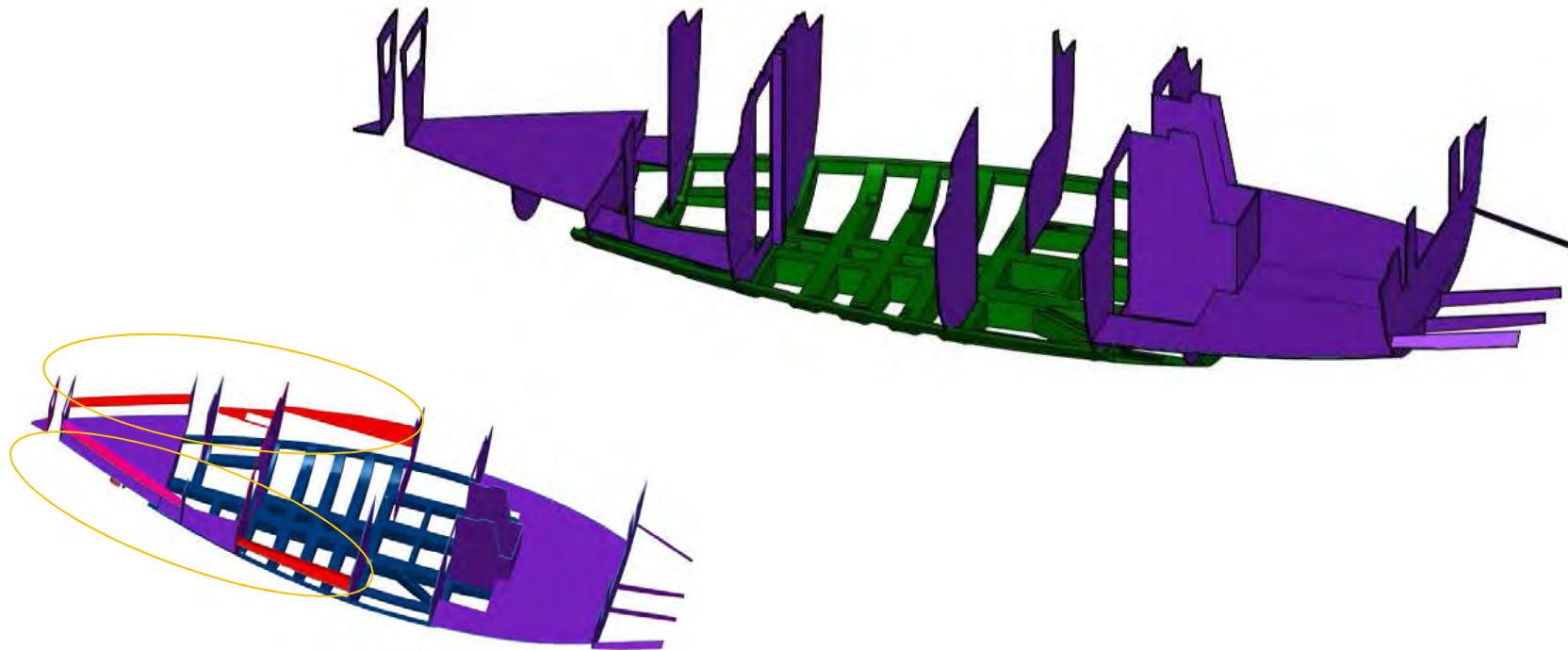

# Cruiser 40 S.

## Under Water Section. Keel Mod.

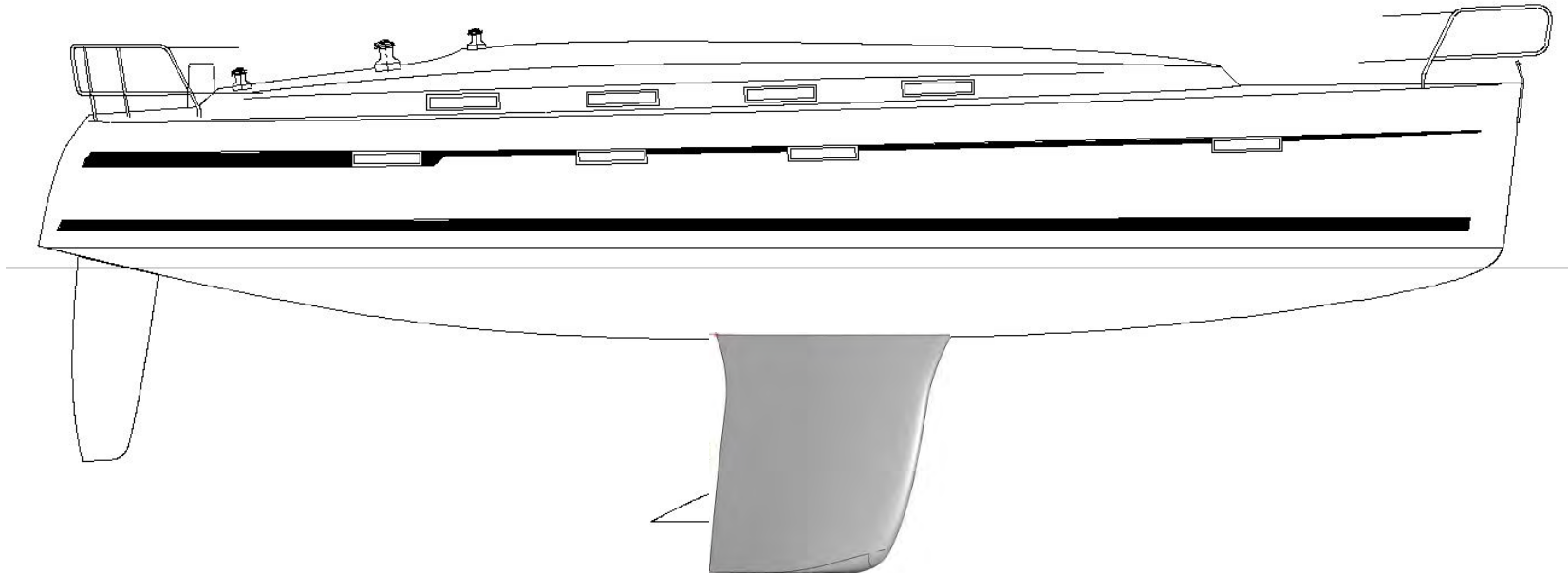

- Hull under water STANDARD
- RS-Keel featuring 2.30m draft (instead of 2.05m at standard deep keel). NEW ERP\_317879
- Rudder blade STANDARD – already finished and shaped

# Cruiser 40 S. Rig & Sailplan.

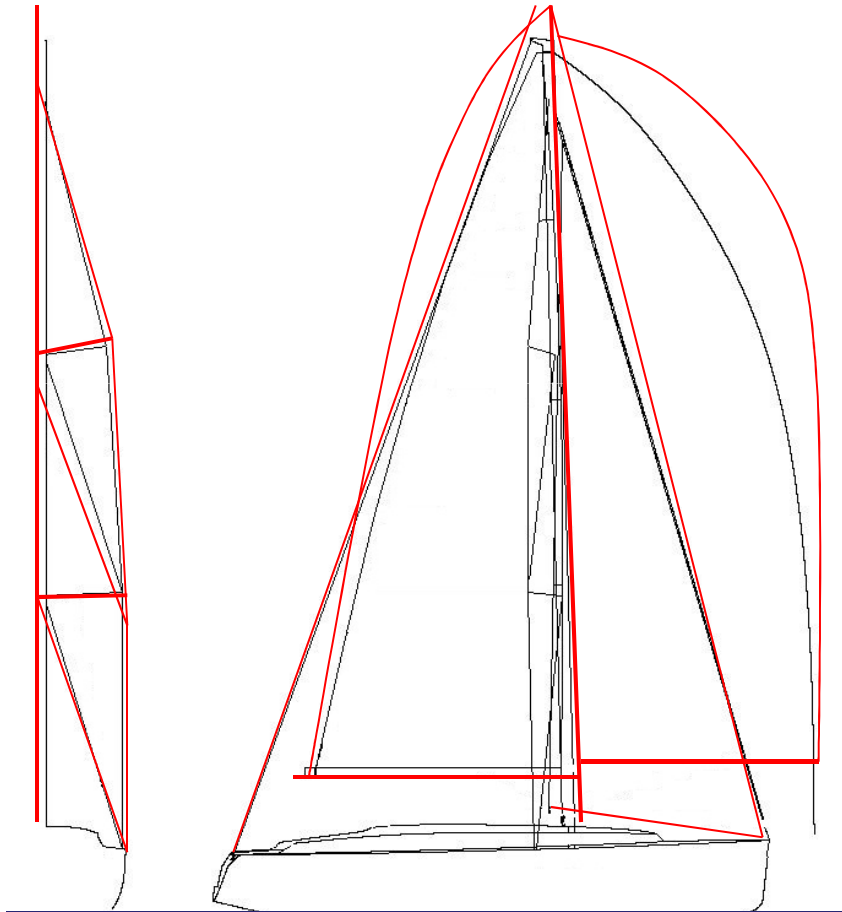

**Mast:** Extended by 60cm.  
 Aluminum mast, deck stepped, 2 spreader.  
**Boom:** Extended by 120cm. Aluminum.  
**Standing rigging:** Dyform Rigging.  
**Spinnaker Pole:** Carbon  
**Backstay Tensioner & Vang:** Hydraulic Integral  
**Running rigging** Liros Race  
**Sails:** Not included

KIT NEW ERP\_317880

**SELDÉN** Rig data no. 8902: BAVARIA 40 CR (10-) RACE

Customer: BAVARIA  
 Sales manager: Jonas Selvik  
 Date created: 10-09-16  
 Latest revision: 10-09-28  
 Not approved

*For quotation only. Specifications may be changed in actual production*

**General rig description**  
 Conventional: Fractional  
 Deckstepped: 2-spreader  
 Untapered: Sloop

**Rig dimensions**  
 Forestay height: FH: 15 360 mm  
 Main sail luff length: P: 15 800 mm  
 Boom height above deck: BH: 1 280 mm  
 Main sail foot length: E: 5 680 mm  
 Main boom sheet pos: S: 5 660 mm  
 Spinnaker pole length: SPL: 4 220 mm

**Chainplates dist. from cl mast**  
 Lateral Long  
 Cap shrouds: 1701 753 mm (23,9°)  
 All towers: 1600 698 mm  
 Deck above chainplates: 482 mm  
 Deck above waterline: 1782 mm

**Hull and righting moment**  
 Length: 11 990 mm  
 Beam: 3 960 mm  
 Draft: 2 050 mm  
 Displacement: 8 000 kg  
 Ballast: 2 560 kg  
 Bulbwing keel  
 Equipped boat  
 Crew incl. in RM: 8 pers.  
 Heeling test RM: 61,0 kNm @30°

**Spar sections**  
 Mast: C245 Furling gear type:  
 Boom: B230  
 Spin. pole: S096

**Furlex**  
 Forestay: 310

**Notes (16 lines)**  
 Preliminary calculations only  
 Righting moment needs to be confirmed

Carbon mast section: CC244-42-00  
 Carbon boom section: BC192-36-04

Optional rod rig:  
 V1: -17/8.4 mm D1A: -17/8.4 mm V2/D3: -17/8.4 mm  
 D2: -10/6.4 mm FS: -17/8.4 mm PS: 12/6.4 mm

Rodkick 30.

RM-calculation:  
 0.94 \* Heeltest RM (empty yacht) +8 crew on rail =  
 0.94 \* 55.3 kNm +9 kNm = 61 kNm  
 (0.94 factor due to reduced displacement)

# Cruiser 40 S. Lewmar Winches.

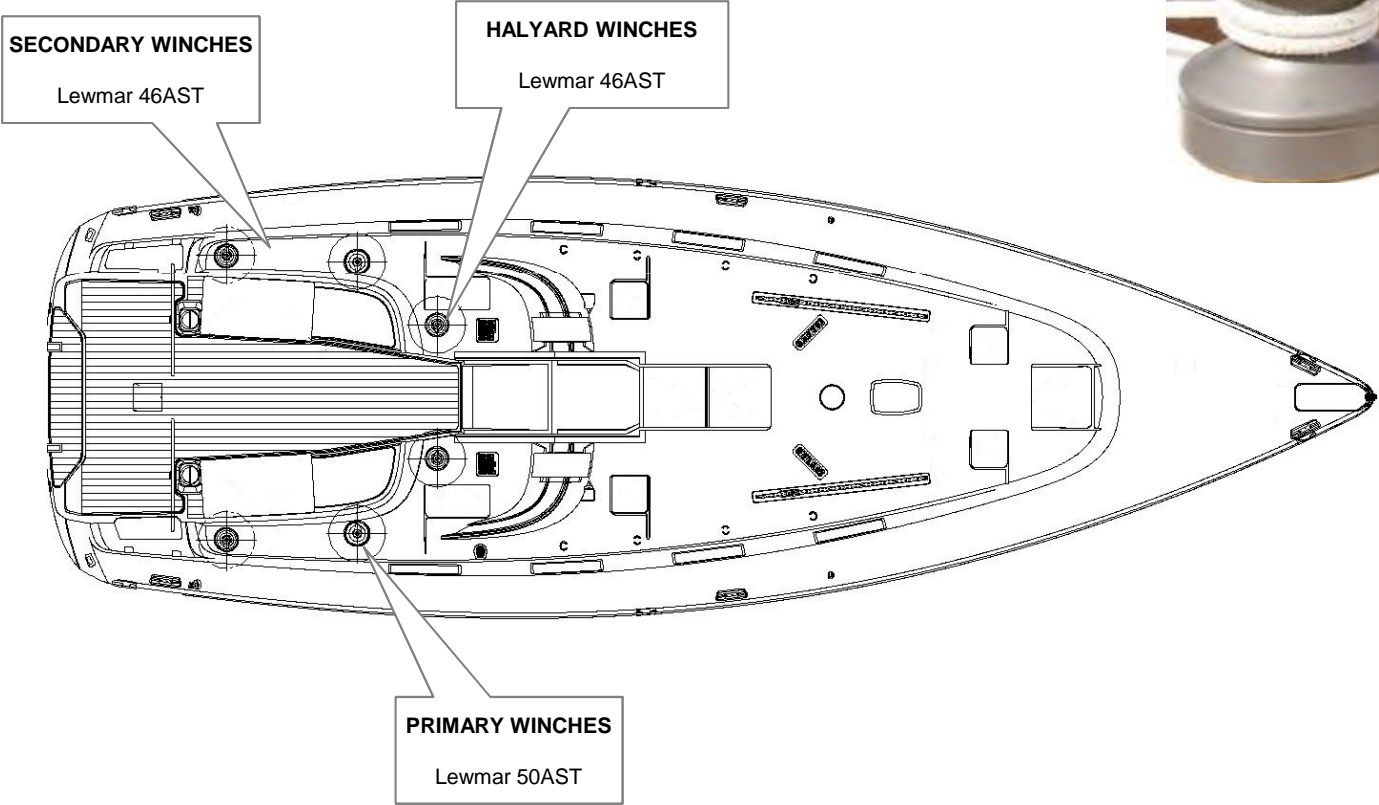

# Cruiser 40 S. Lewmar Steering.

Upgrade of the steering system into a "Mamba Torque Tube" system providing more ruggedness and better feeling of the rim load while sailing.

NEW ERP\_317882 for Upgrade Kit

Replacing:

- Current steerer
- Chainsets
- Chain Idler
- Steering Wheels – swopping into Composite wheels  
-(NEW ERP\_317884)

Staying in the system:

- Rudder stop
- Reduction Gearbox
- Tiller Lever
- Draglink
- Keeping the Wide Angle Geometry in the system

-Extra weight approximately 8kg for hardware

No change of milling in deck required.  
No change of steering chassis required.

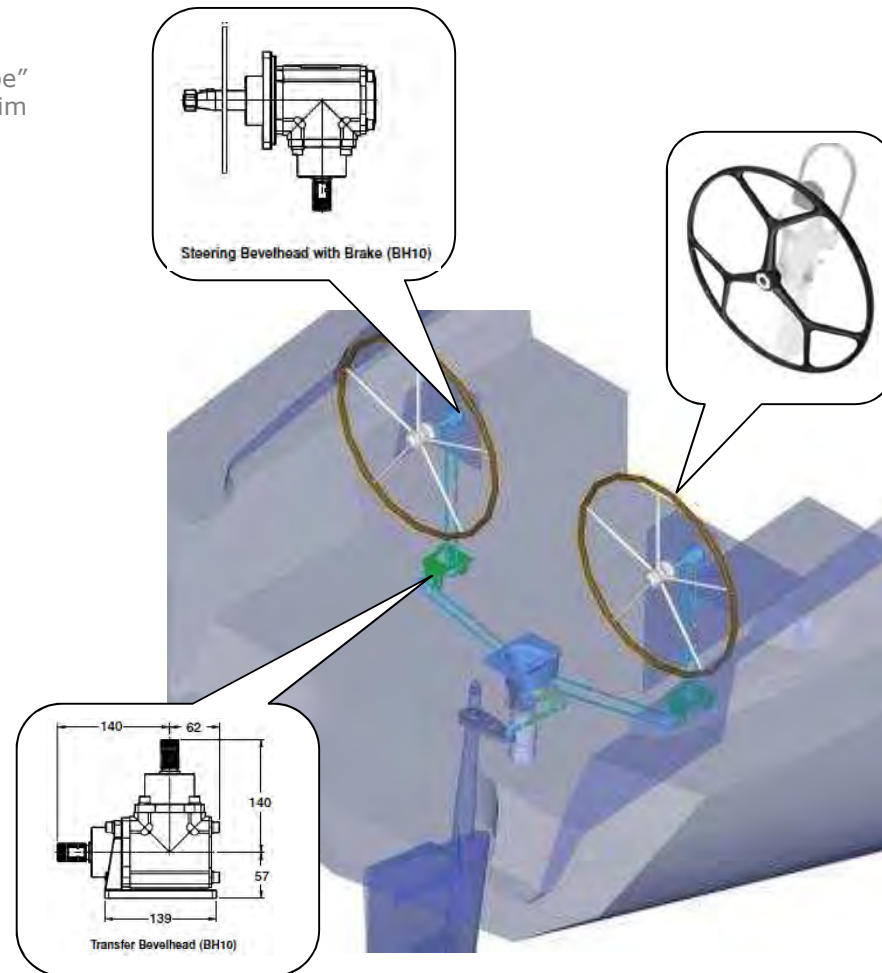

# Cruiser 40 S. Seldén Genoa Car & Trim Line.

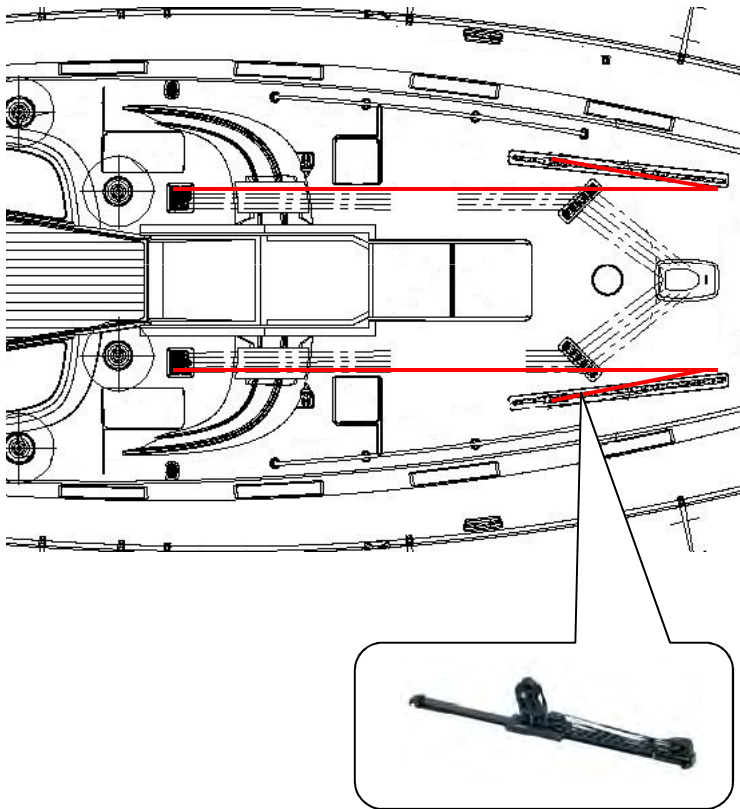

**Separate Item:**

2x 443-002-03 Track, 150cm length

**Supplied in BOM**

2x 443-125 Endstop

2x 443-303-02 Control Line Endstop 2 shv,

2x 443-300-02 Genoa Car

4x 443-219-01 Bulls Eye

2x 433-611-02 Swivel Cleat Eye

**Note:**

Ball bearing Car, Endstop, Bulls Eyes and cleat or clutch. 4:1 purchase.

Option to upgrade to 5:1 by adding a cascade into the system.

No change in CNC milling.

**Complete S-Hardware package: ERP\_317881**

# Cruiser 40 S. Seldén Mainsheet Traveler & Blocks.

Mainsheet blocks on boom:  
2x 406-201-01 RBB60 Single Block  
1x 406-201-05 RBB60 Double Block

**Separate Item:**  
1x 443-011-03 Track, 150cm length  
**Supplied in BOM**  
2x 443-135 End Mount Fitting  
2x 443-303-02 Control Line Endstop 2 shv,  
1x 443-301-02 Mainsheet Car  
2x 406-001-19 Double Jamming Footblock

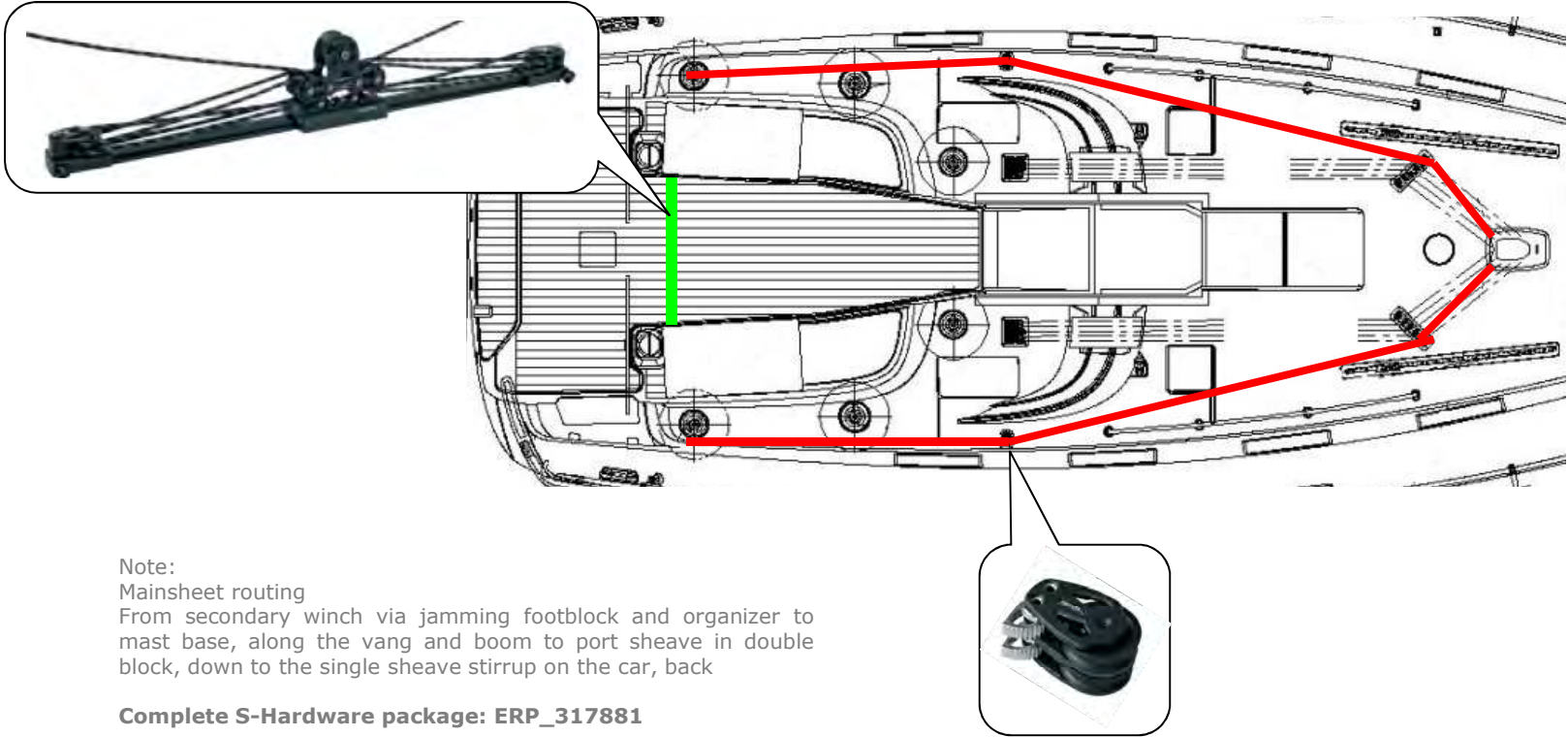



# Cruiser 40 S. Seldén Spinnaker Sheeting.

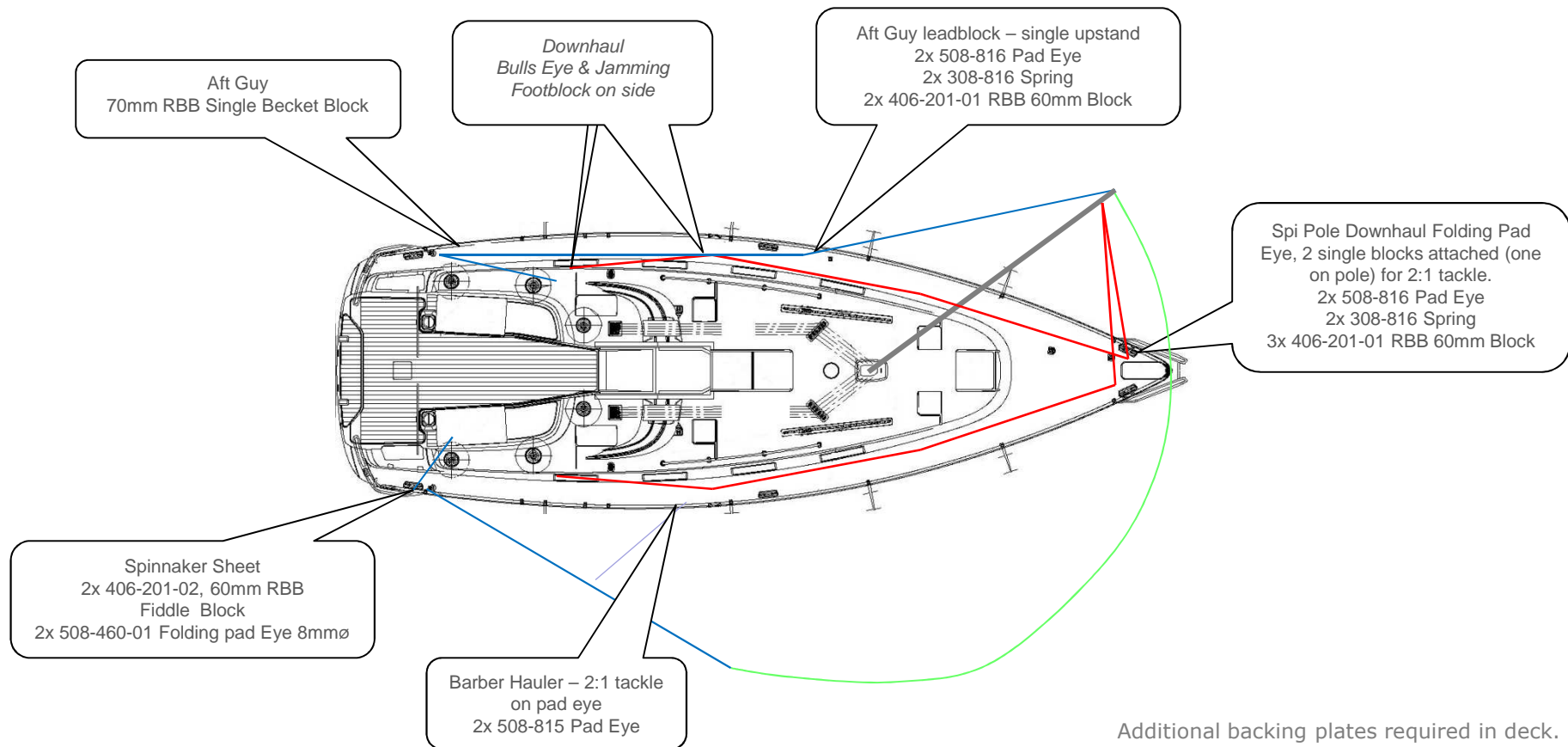

Additional backing plates required in deck.

Graphic is showing line layout for one side only – both sides fitted.

**Complete S-Hardware package: ERP\_317881**

# Cruiser 40 S. Halyards and Lines. Deckhardware.

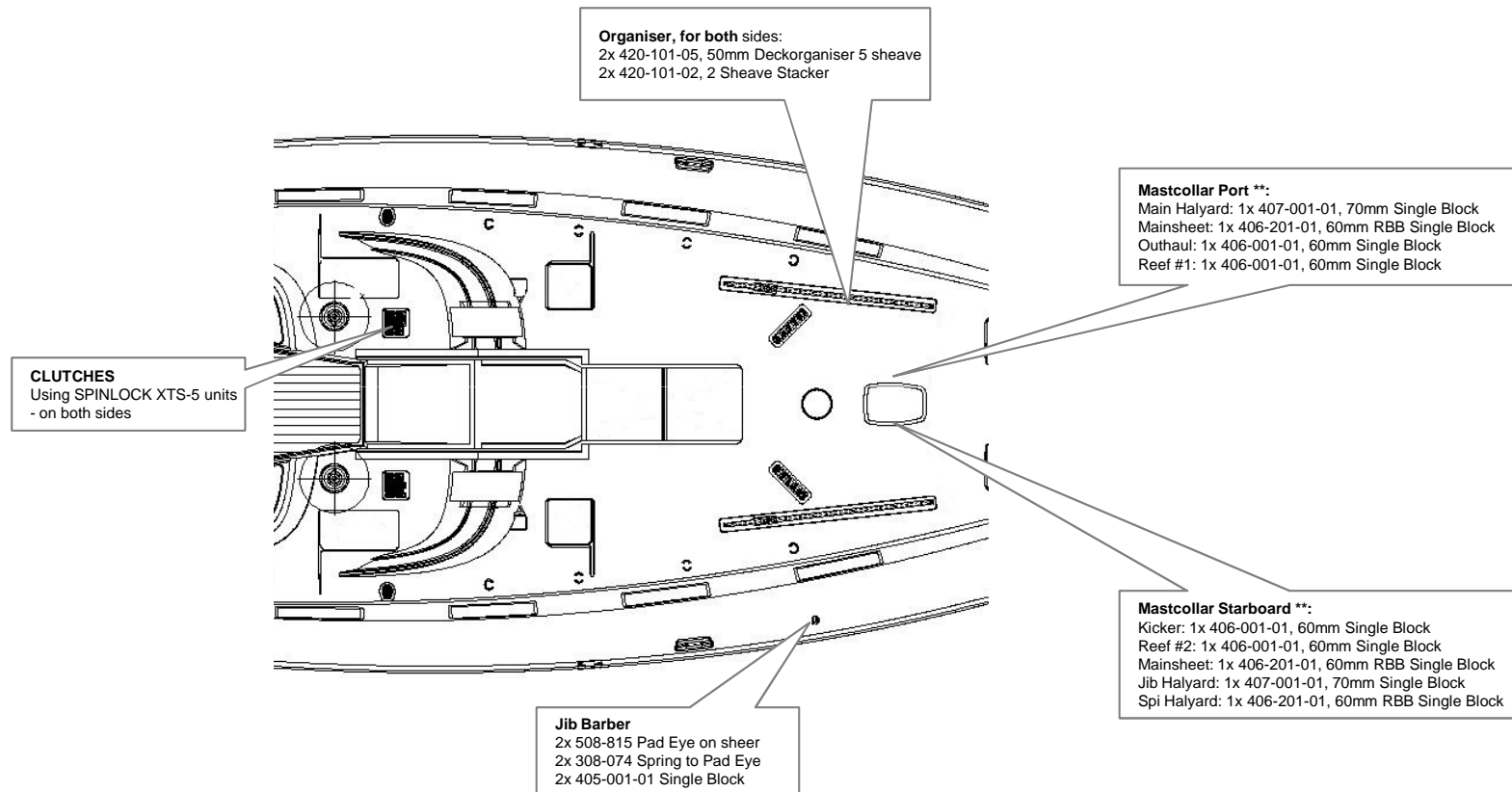

Note:  
Plain Bearing Blocks (PBB) in use for static loads.  
Roller Bearing Blocks (RBB) in use for fast moving lines

**Complete S-Hardware package: ERP\_317881**

# Cruiser 40 S. Halyards & Lines. Lower Stack.

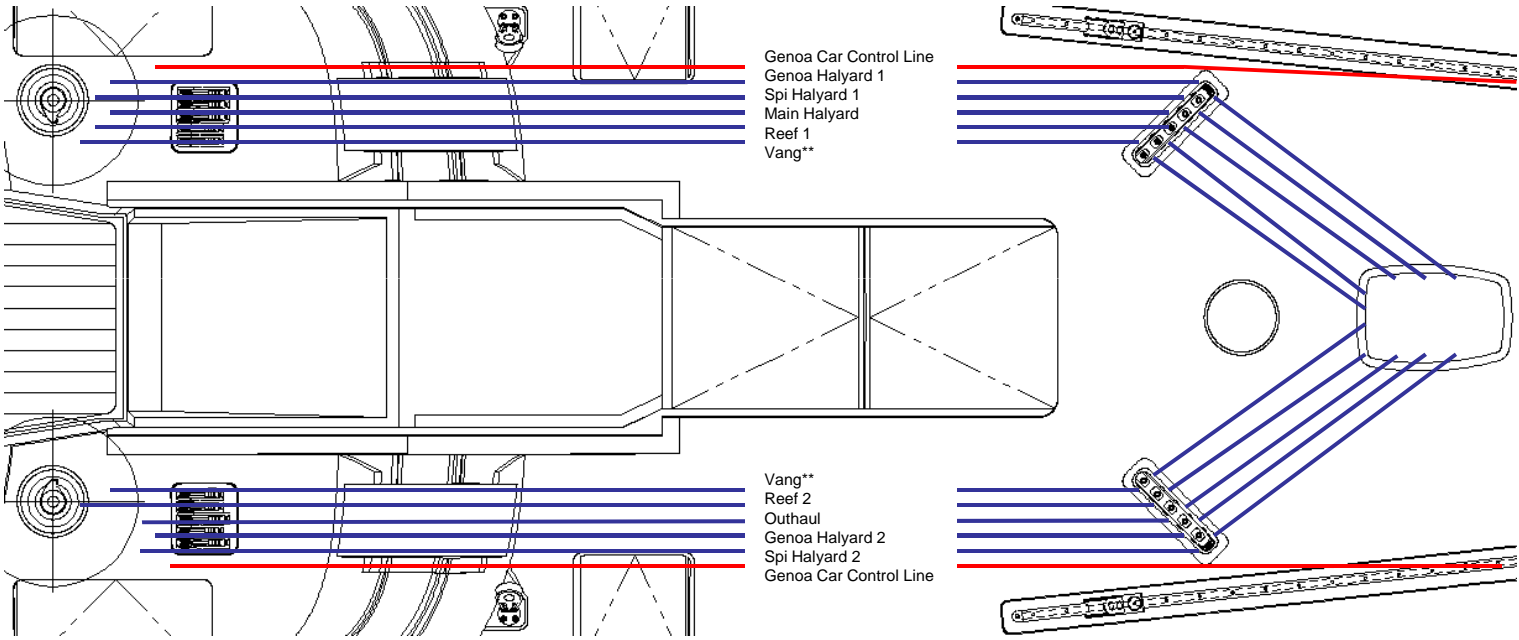

\*\* Alternative fitting: Running inside of the clutches via single upstand block each and ending on a swivel cleat – both sides

# Cruiser 40 S. Halyards & Lines. Upper Stack.

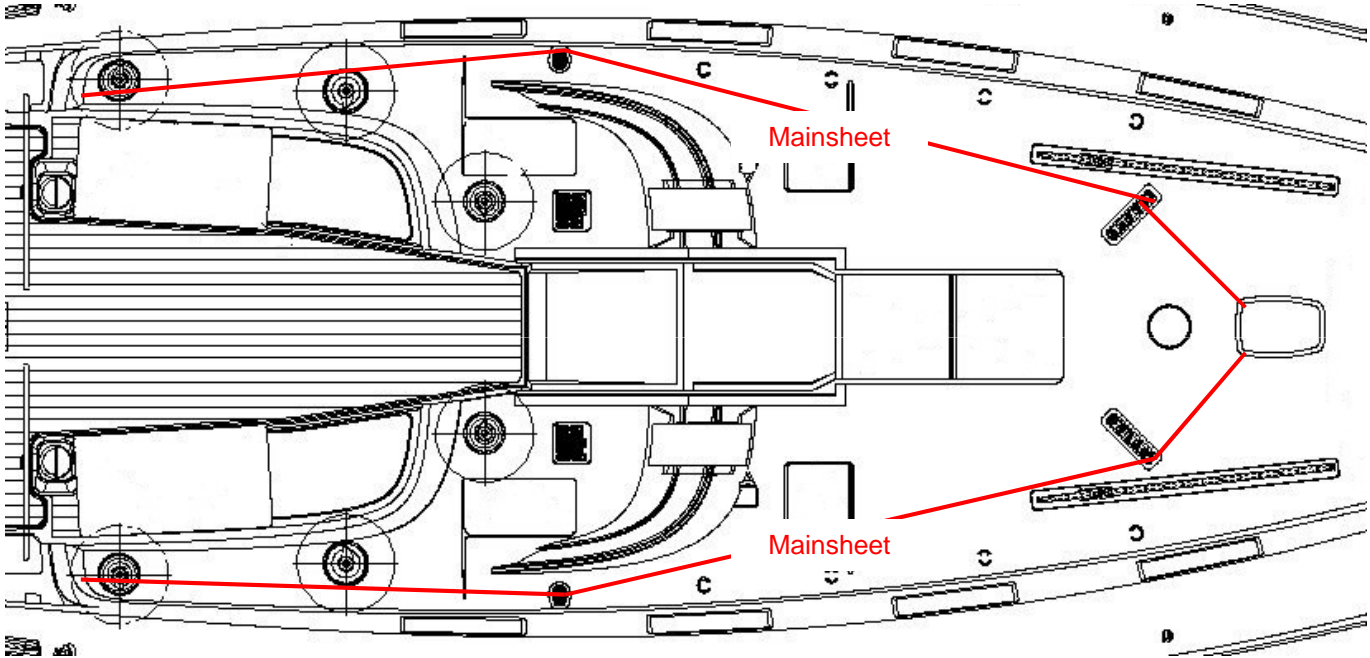

Complete S-Hardware package: ERP\_317881

# Cruiser 40 S.

## Concept Various Items. Outside.

### COCKPIT TABLE

To create working space in the cockpit, the table will be not fitted.  
The Upgrade cockpit table is optional available.

### PLATFORM

Not in standard – demounted for race sailing.

For cruising the OPTIONAL platform can get mounted by using the standard mounting holes applied.

The recess of the hinges is covered by a stainless steel unit using and sealing the 4 mounting holes per side. NEW ERP\_317883

### TOE RAIL

For hiking of the crew on the rail, the toe rail needs to be flat from stern to V1/D1 chainplate.

306555 Relingsstütze Matchserie

306556 Relingsfuss "Match-Serie"

310269 Relingsschiene "Match-Serie"

310286 Reling-Endstück BB-Seite "Match-Serie"

310287 Reling-Endstück STB-Seite "Match-Serie"

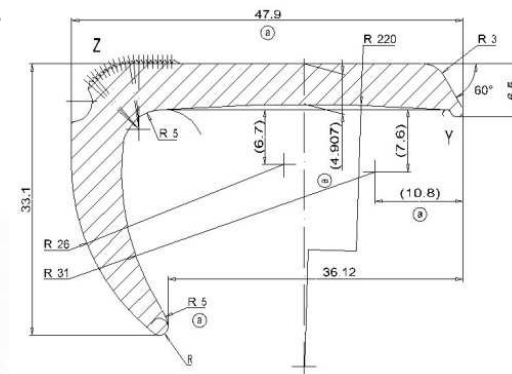

# Cruiser 40 S.

## Concept Various Items. Interior.

### **FORWARD HEAD – converted into sail locker / storage**

The forward head will be empty (no toilet, tank, water tap, bowl, ...) fitted. Instead of this, the cell will feature a shelf for storing material and equipment and a hanger for foul weather gear. Plus offering sound space to stow the required additional sails for racing.  
NEW ERP\_317887

Aft head on port is untouched and offers the optional shower with separation.

### **MAIN CABIN - LONGITUDINAL BANK**

This bank is NOT included in the standard specification but can be ordered optional.

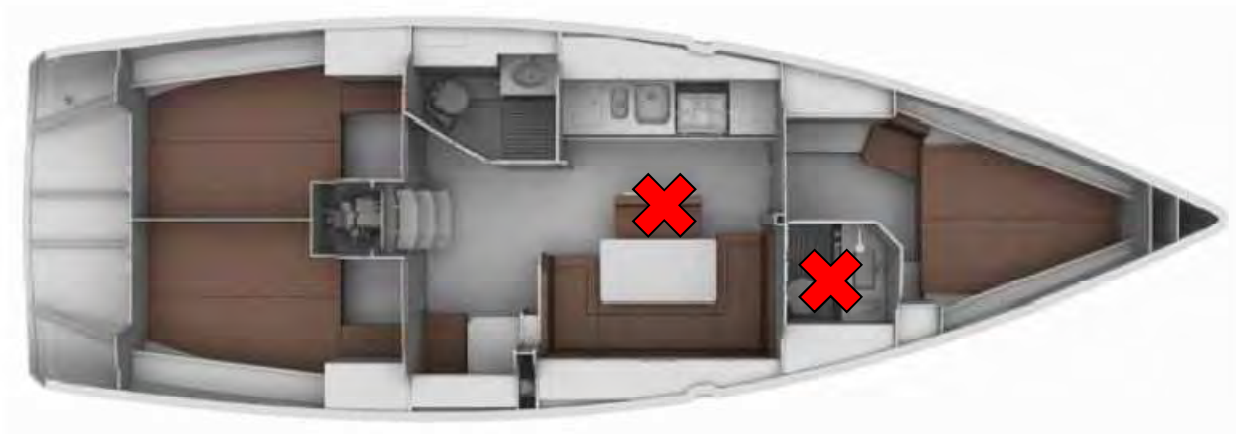

# Cruiser 40 S. Info. Electronics.

The best possible package available for the `Cruiser 40 S` will be the optional TACKTICK system featuring:

1. 1x Masthead unit
2. 3x Jumbo Units on a Mast Bracket
3. 1x each Speedo, Depth Sounder & compass
4. 1x Multi Dual Display
5. 1x NMEA Interface Unit
6. 1x Handheld Remote Control with Multi Function Display
7. 1x Magnetic Handheld Compass

All wireless connected  
Solar charged units  
All you need for racing.

Linkable to all GPS systems and  
plotters via NMEA 2000.

NEW ERP\_317885 for Kit





VIELEN DANK FÜR IHRE  
AUFMERKSAMKEIT.