

### 4.4 Seldén Code X, Furling system for gennaker, Code 0 and stay sail

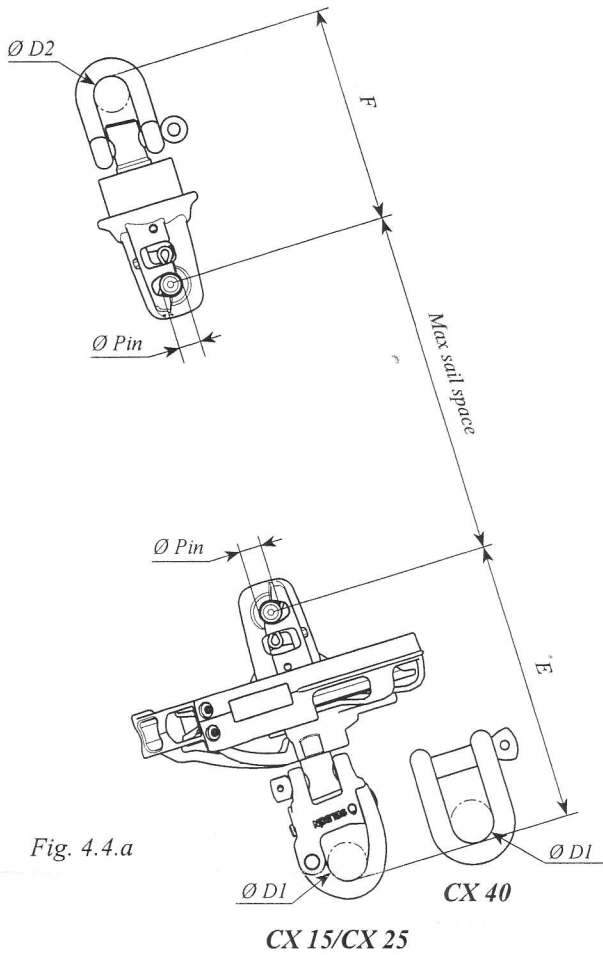

 See manual 595-731-E for further information.

Fig. 4.4.a

System	Maximum sail space (Measurement calculated from halyard shackle to fastening device on boat/bow sprit)			D1 mm	D2 mm	Ø Pin mm
	E mm	F mm	F+E mm			
CX15	125	95	220	16	12	10
CX25	155	120	275	22	20	12
CX40	165	145	310	24	24	14

#### Thimbles for Torque rope

System	Ø Hole mm	Max rope D3, mm	W1 mm	H1 mm
CX15	10,3	8	16	43
CX25	12,3	11	19	55
CX40	14,3	11	19	55

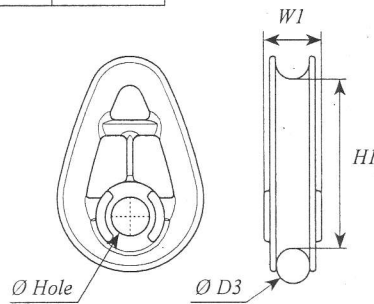

Fig. 4.4.b

#### Thimbles for double Leach rope

System	Ø Hole mm	D4 mm	W2 mm	W3 mm	H2 mm
CX15	10,3	8	16	22	34
CX25	12,3	8	19	27	42
CX40	14,3	12	20	33	52

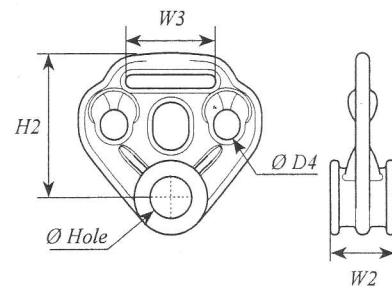

Fig. 4.4.c