

Halyard exit

505-021-01 (18mm)

Fitting Instruction

Tools needed:

Pencil, Jigsaw, Ruler, Half round file, Drill, Poprivet gun, Ø 4.9 mm drillbit, Hammer, Ø 22 mm holesaw, Mandrel

Fasteners: 1 poprivet LD639 (Ø 4.8 x 9.9)

Location on the mast:

The exits should be located 300 mm apart, vertically, to maintain the strength of the mast. It is acceptable to fit one exit on each side of the mast, at the same level. When the fitting is used as a spinnaker halyard inlet, it should be located 500-1000 mm below the headbox, 12-30 mm from the front line of the mast and 250 mm apart, vertically



Fitting procedure:

1. Draw a line parallel with the longitudinal axis of the mast and mark the two holes for each fitting.
2. Pre-drill with the Ø 4.9 mm drillbit.
3. Enlarge the holes to Ø 22 mm, using the holesaw.
4. Draw straight lines between the Ø 22 mm holes, one on each side, touching the whole edges.
5. Check that the distance between the lines is equal to the dimension of the part of the fitting, which should fit into the slot.
6. Saw along the "inner edges" of the lines, so that the width of the slot will be the same as that of the lugs of the fitting.
7. File the edges of the slot. They must be smooth without any notches.
8. Insert the fitting into the slot. Check that it is fitted the right way up, and push it upwards so that its upper end is held in place by the mast wall.
9. Drill Ø 4.9 mm for the poprivet, using the fitting as a jig.
10. Pull the rivet. Remove the remaining rivet mandrel using a mandrel and hammer.

Measurement: (NB: Not to scale)

UP

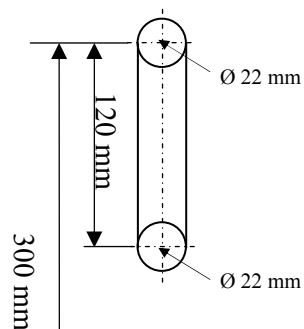

DOWN

