

# Gennaker pole kit

595-246-E  
2007-10-15

## Assembly instruction for gennaker poles

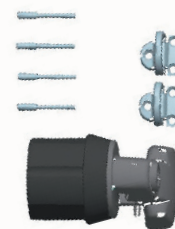
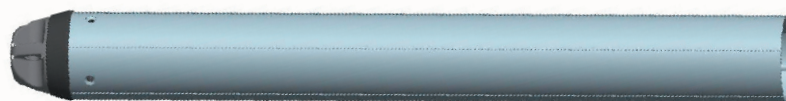

### Tools Required:

Saw  
Drill  
Ø 6.5 mm drill bit  
Screwdriver torx  
Hammer  
Pop Rivet Gun

### Parts included in kit

Extrusion with outboard end fitted  
Inboard end  
Fasteners  
Pad eyes (screw M6 not incl.)

### Assembly

1. Mark the length of the extrusion, see table 1 for reductions.  
(Use a paper as a guide as fig. 1). Cut the extrusion.
2. Mark the holes for the rivets, according to table 1.
3. Drill the holes with a Ø 6.5 mm drill bit.
4. Fit the inboard end with pop-rivets and punch out the mandrel heads.

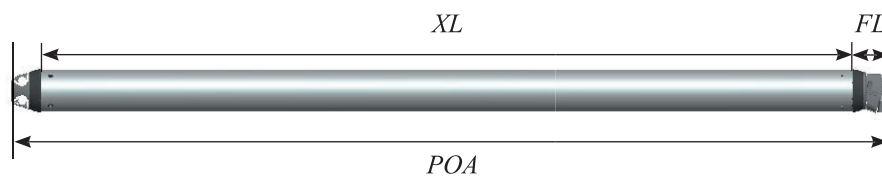
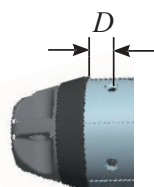
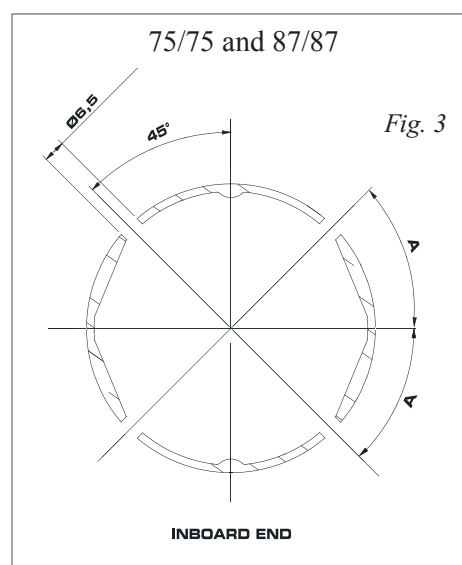
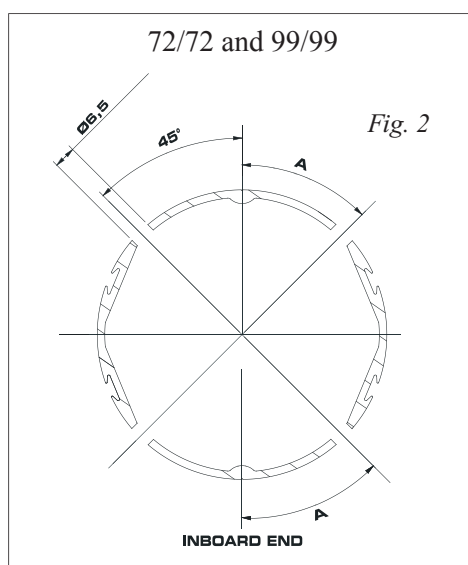
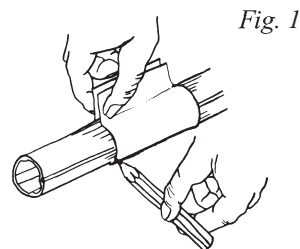

Extrusion	A	D	Extrusion length
72/72	29	40	XL = POA - 78
75/75	30	40	XL = POA - 78
87/87	34	20	XL = POA - 122
99/99	39	20	XL = POA - 158

Tab. 1